



# Alexander Hudson Estates

---

Sales Particulars

# Alexander Hudson Estates

Mill View, Backworth, NE27



# The Property

Alexander Hudson Estates introduces to market this three-bedroom, detached family home located within the increasingly popular area of Backworth, NE27.

This beautifully presented home is stylishly finished throughout and offers spacious, modern living accommodation. The property comprises an inviting entrance hallway, downstairs WC, comfortable living room, and a bright contemporary kitchen/diner ideal for both everyday living and entertaining. A utility area has been created in the garage, complete with electrical and plumbing connections for freestanding appliances and sink.

To the first floor are three well-proportioned bedrooms and a generous family bathroom, with the principal bedroom further benefiting from a private en-suite shower room.

Externally, the property features a paved private driveway providing ample off-road parking and access to the integral garage. To the rear is a sunny enclosed garden with a patio area, lawn, and garden shed perfect for relaxing or outdoor entertaining.

Backworth Park is part of the historic village of Backworth, known for its mining heritage. The modern development has created a thriving residential community with contemporary homes, local shops, and leisure facilities including The Pavilion Bar & Grill, Costa Coffee, and a local retail centre. Coastal towns such as Whitley Bay and Tynemouth are a short drive away, while the A19, A1, and Northumberland Park Metro Station provide excellent commuting options. Families benefit from nearby primary and secondary schools, making Backworth Park a convenient and attractive location with a strong sense of community, just a stone's throw from the coast.

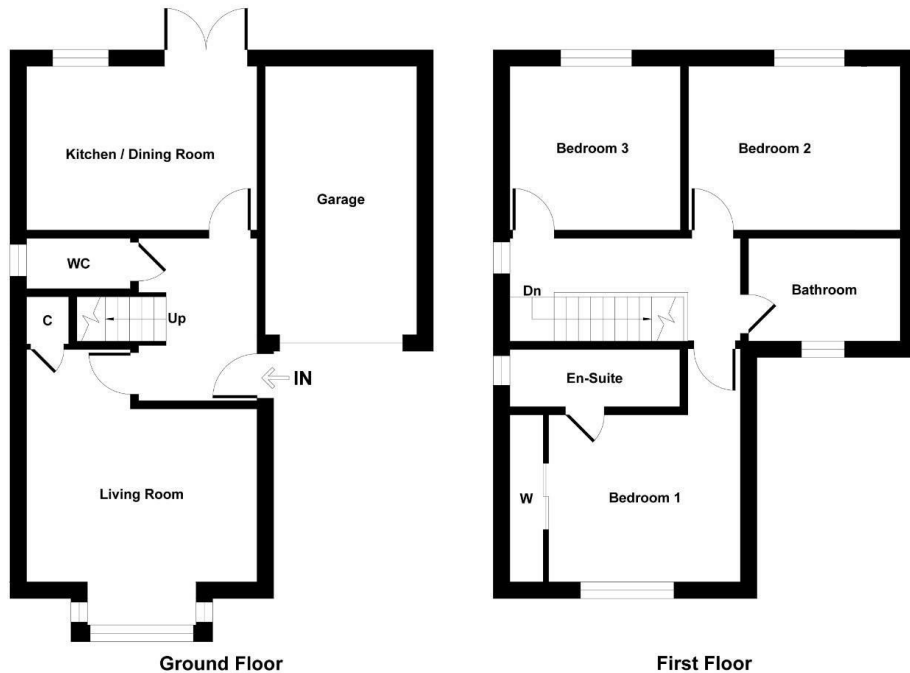
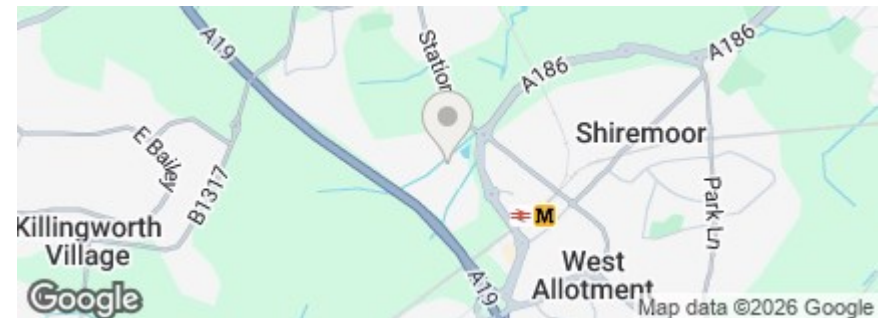

Illustration for identification purpose only, measurements approximate and not to scale, unauthorized reproduction is prohibited. All rights reserved for Alexander Hudson Estates

Leasehold  
Council Tax: C  
EPC Rating: 82





---

Alexander Hudson Estates  
The Printworks  
20 Arrow Close  
NE12 6QN

0191 268 7433  
[sales@alexanderhudson.co.uk](mailto:sales@alexanderhudson.co.uk)